

MANOR

12 BATH ROAD
SWINDON | SN1 4BF



A well-presented one-bedroom apartment offering spacious living accommodation arranged over two floors.

This characterful maisonette-style flat is ideally suited to professionals or first-time buyers seeking a distinctive home in a convenient location.

The accommodation comprises a welcoming entrance leading to a comfortable reception room and kitchen, There is a well proportioned bedroom and bathroom, ensuring privacy and practical day-to-day living.

Maintained in good condition throughout, this home is ready to move into and offers a fantastic opportunity for those looking to get onto the property ladder or seeking a comfortable base in Swindon. Bath Road provides easy access to local amenities, transport links, and the town centre, making this an excellent choice for commuters and those wanting to enjoy everything Swindon has to offer.







- Modern Specification
- Split Level Apartment
- Open Aspect
- Fantastic Transport Links
- Amenities Nearby

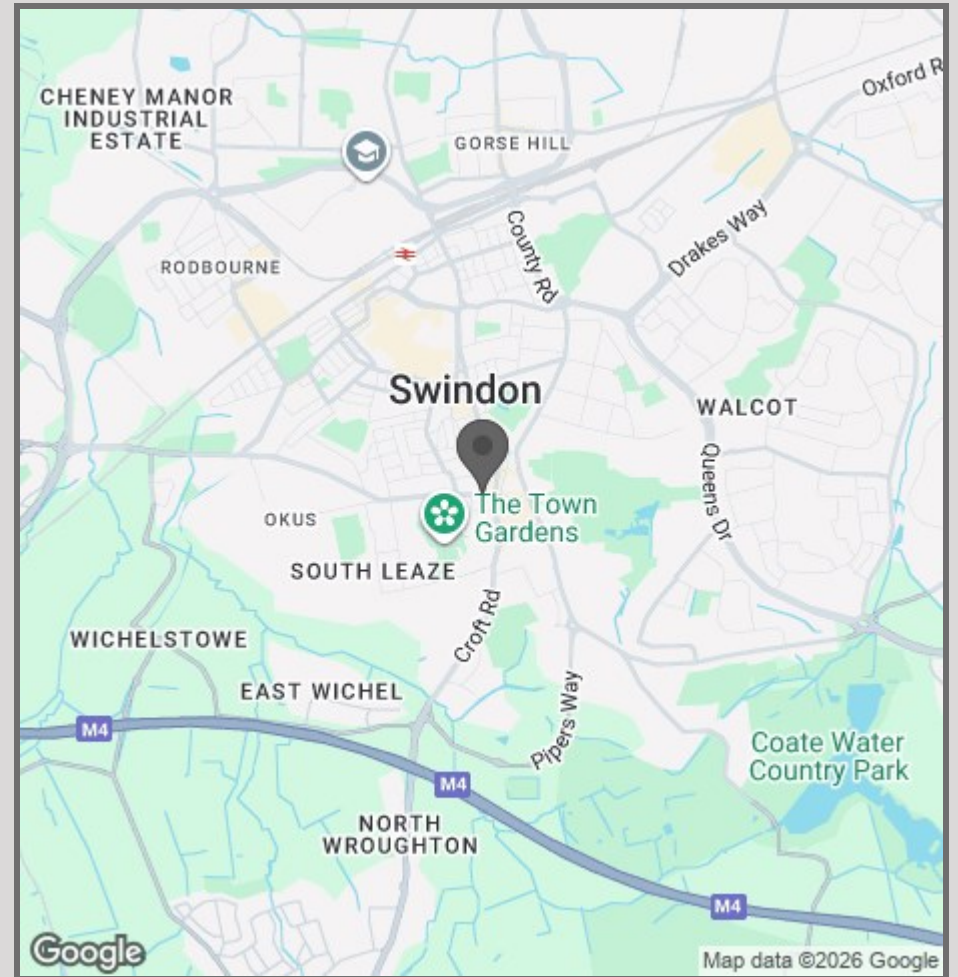

42 High Street
Woodstock
OX20 1TG

01865 955500

hello@manoroxford.com

www.manoroxford.com

MANOR

Ground Floor

Approx. 31.0 sq. metres (333.9 sq. feet)

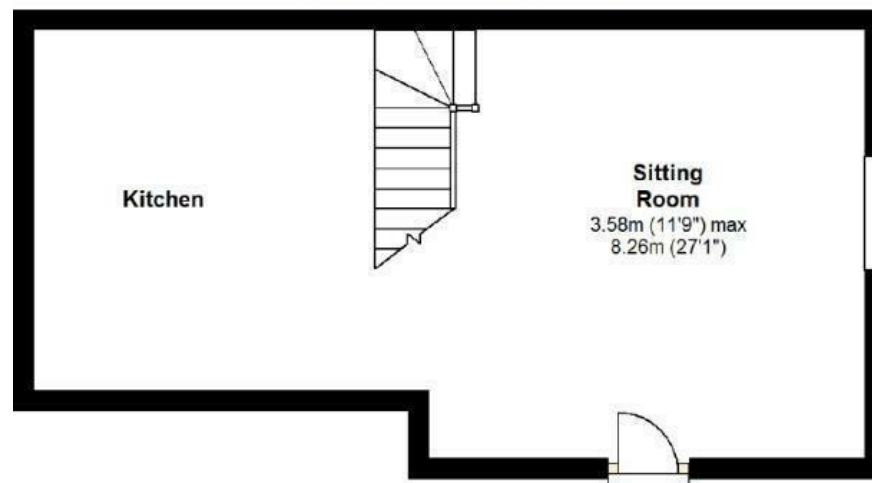

Basement

Approx. 29.1 sq. metres (313.2 sq. feet)

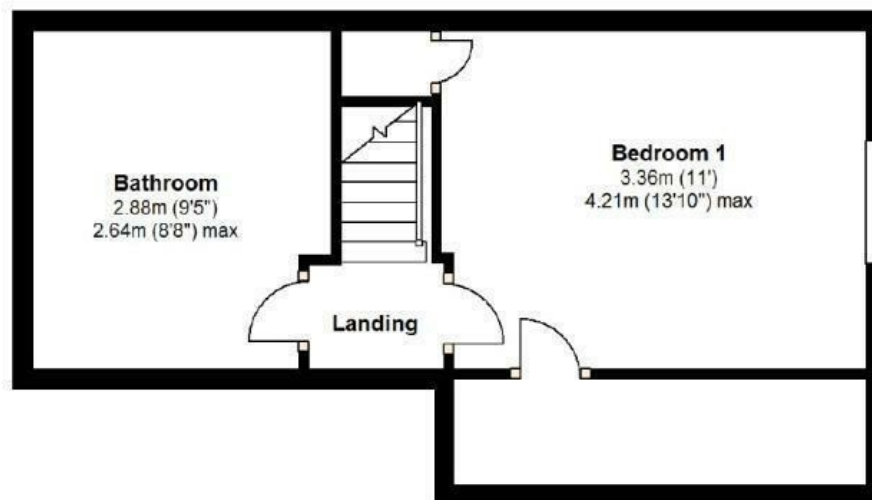

Total area: approx. 60.1 sq. metres (647.0 sq. feet)

M A N O R